

## **Angel Bead**

The angel bead will prevent the fracture or crack by the flat side formed on ridge of the plaster project. It can also protect and reinforce the most dangerous parts. Its wing will embed deeply into the plaster randomly. The angel bead is important for the plaster as the plaster corner easily emerges damages during or after the construction. The angel bead will reinforce the firmness of the wall as it is easy to construct and reduce time. The angel bead is widely used as it is easy to operate and reinforce the wall corner.

## **How to Make Use of Angel Bead**

- 1.1) If the building is less than 2 meters above the ground, we can construct by level bar;
  - 2) If more than 2 meters, we need to construct thread drawing;
  - 3) No constructing if it rains.
- 
2. We need to fix the angel bead strip on the wall after covering cement mortar of 4-6mm on the wall. Press the wall and make the cement mortar flow out of the meshes.
- 
3. 12 hours later, we can carry out next working procedure in order to prevent the cement mortar from shifting or being out of shape before congealing.
- 
4. We need to arrange people to paste the angel bead (The angel bead strip should be vertically fixed full of cement mortar). Perpendicularity error should be within 2mm and it should be seriously operated.

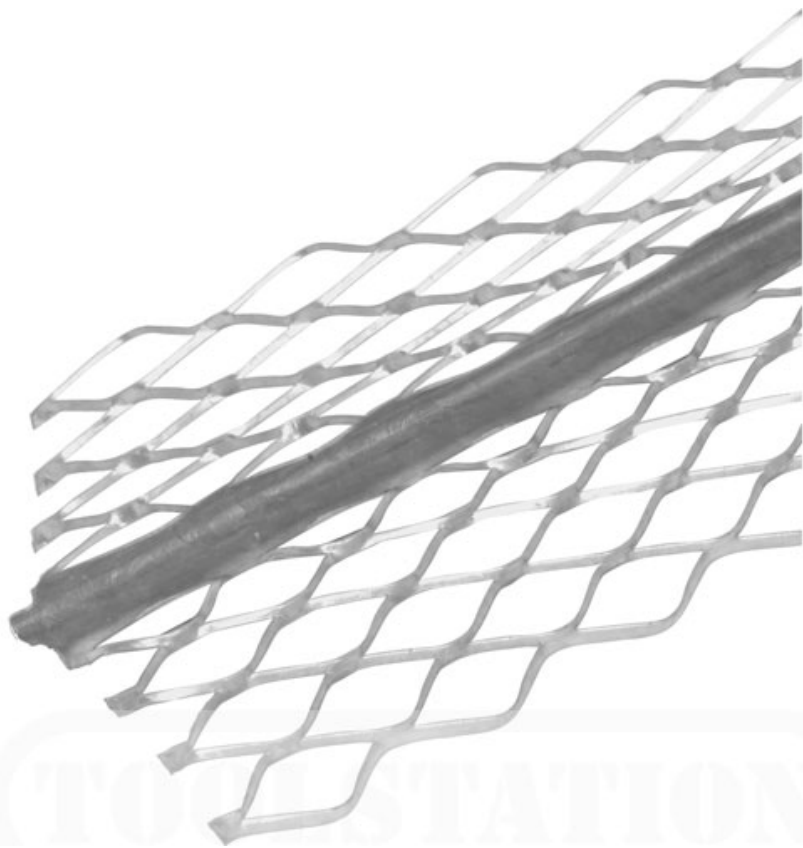
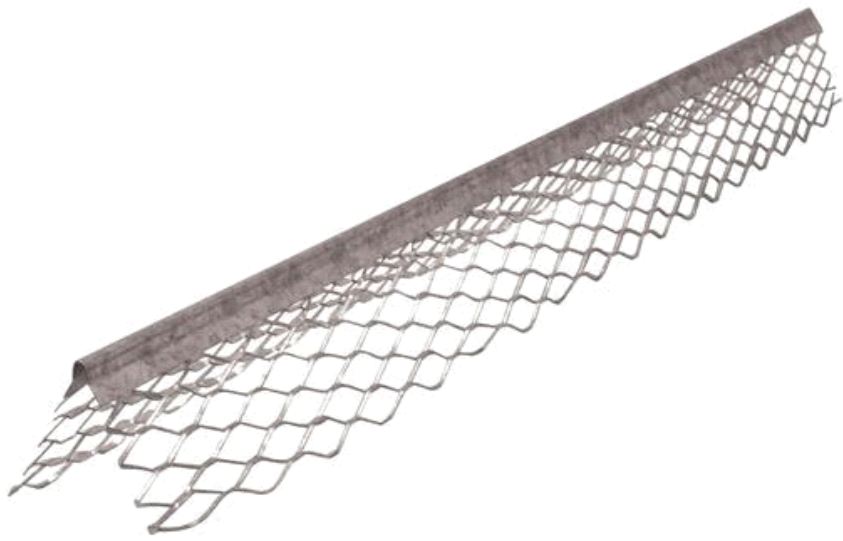

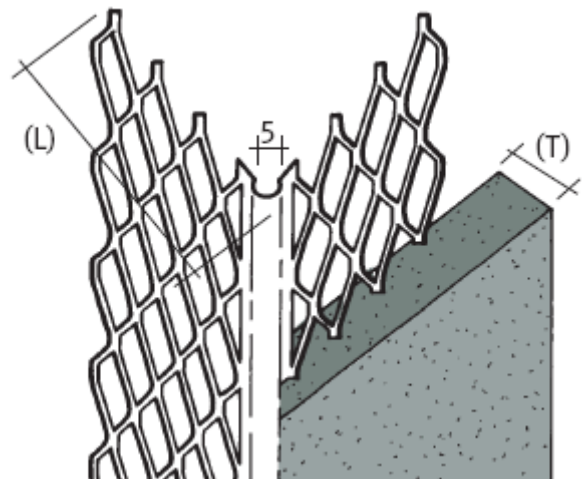
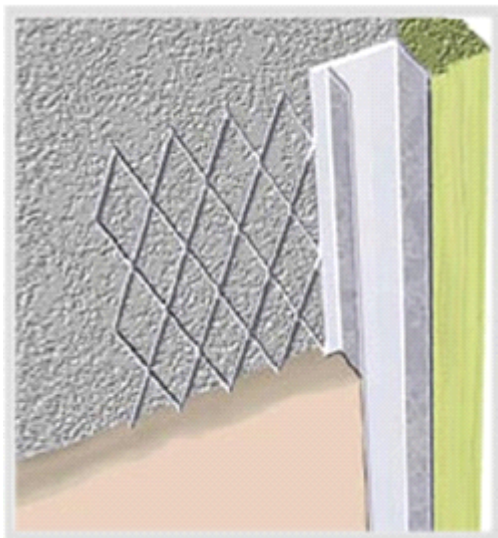
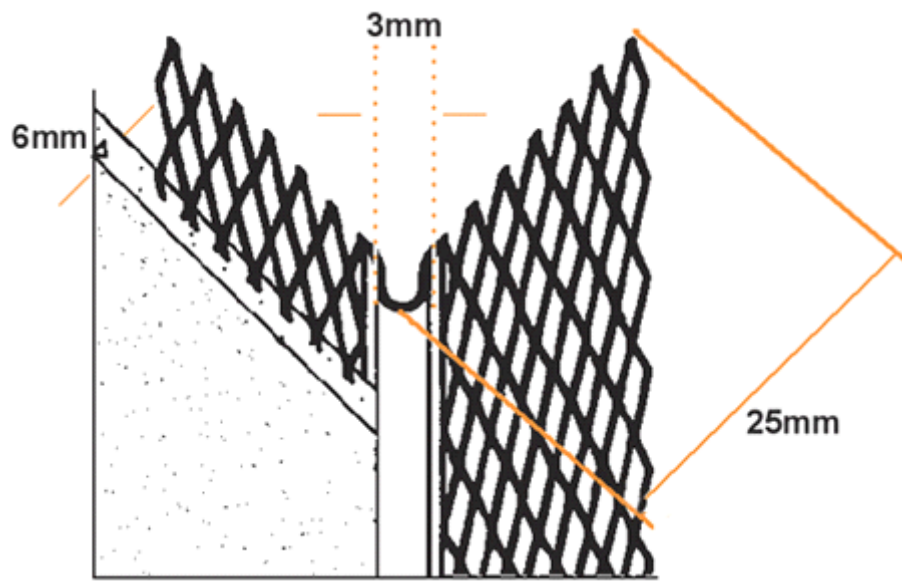
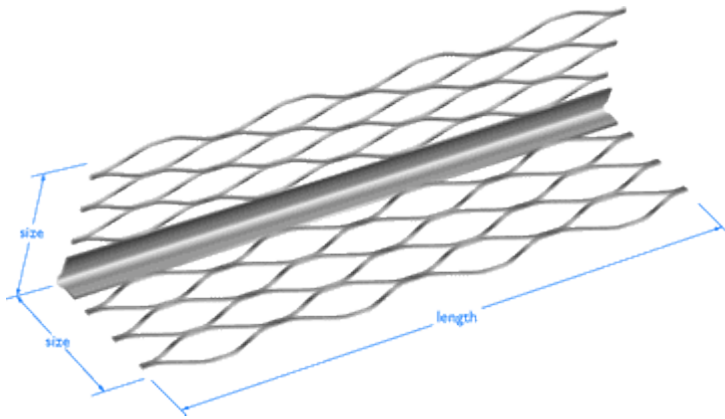

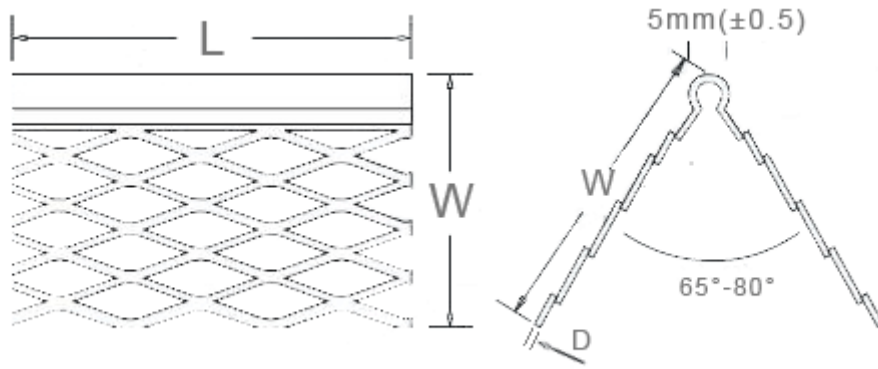

ANGLE BEAD

